

QSL24100

LiFePO4 lithium accu 100Ah 24V met Bluetooth

Producttester: Zeer goed

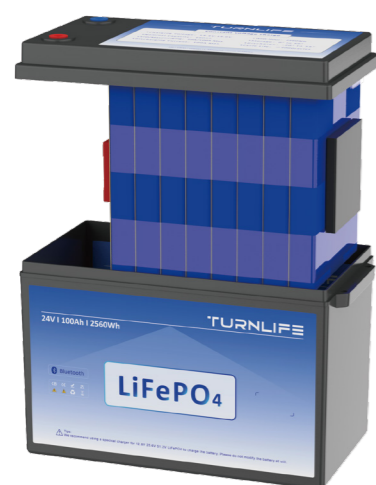

1.M8 pure copper 2.handle 3.Safety cells

•Applications and features

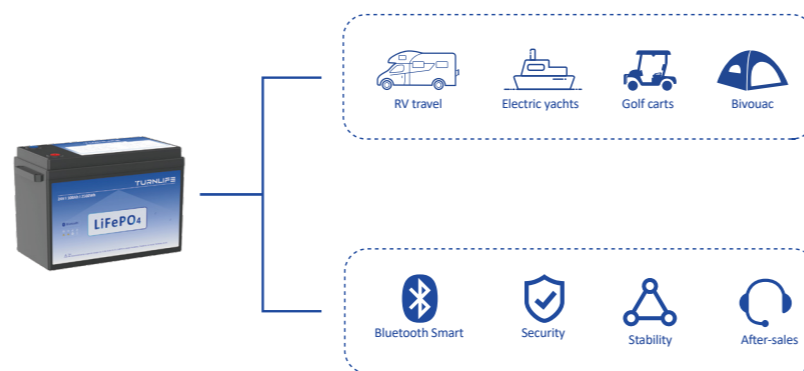

•Packaging and size

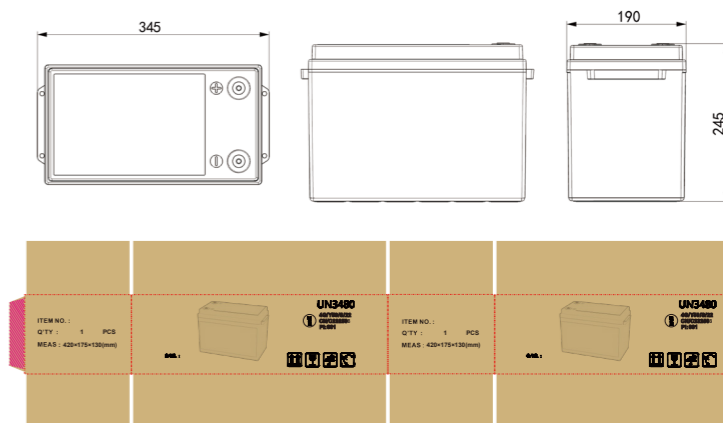

PRODUCT PARAMETER

Specifications

Watt-Hour	2560Wh
Capacity	100Ah
Voltage	25.6V
Weight	22kg
Dimension	345*190*245mm
BMS	Yes
Efficiency	98%
Max charge/Discharge Current	100A
Max Charge/Voltage	28.8V-29.2V
Cut-off Voltage	18.4V-20V
Peak Discharge	200A 0.5s
Storage	0° to 50°
Discharge	-20° to 55°
Low Temp Charging Protection	Yes
Connection Capability	Max 2S-16P
Warranty	5 years